





The Letcombe Register



Issue 194

October 2021

VILLAGE DIARY

| Mon | Tue | Wed | Thu | Fri | Sat | Sun |
|---|--|---|---|---|---|---|
| | | | | 1 | 2 <u>Tennis Cardio</u> 9 - 10am Junior Tennis Coaching 10 -2 Football 3pm | 3 <u>Tennis Mix in</u> 10.00am |
| 4  Voices of the Vale 7-9 pm Village Hall | 5 Yoga w Beth 0945-1045 Village Hall (please book) | 6 <u>Tennis Cardio</u> 9 - 10 Coaching 10 -11 | 7 Pilates with Rachel 9.30 am Village Hall Yoga w Diana 11.15-12.30 Village Hall | 8 King Alfred's Academy Walk 9.15am-1pm | 9 <u>Tennis Cardio</u> 9 - 10am Junior Tennis Coaching 10 -2 Football 2pm | 10 Autumn Adult Tennis Tournament 10am - 1pm Holy Communion 10am Pub Quiz 8pm |
| 11  Voices of the Vale 7-9 pm Sports Pavilion | 12 Yoga w Beth 0945-1045 Village Hall (please book) | 13 <u>Tennis Cardio</u> 9 - 10 Coaching 10 -11 Film Club 8pm Village Hall 'Official Secrets' | 14 Pilates with Rachel 9.30 am Village Hall Yoga w Diana 11.15-12.30 Village Hall | 15 | 16 <u>Tennis Cardio</u> 9 - 10am Junior Tennis Coaching 10 -2 Nature Reserve Work Party 1.30-4.30pm Football 3pm | 17 <u>Tennis Mix in</u> 10.00am |
| 18  Voices of the Vale 7-9 pm Village Hall | 19 Yoga w Beth 0945-1045 Village Hall (please book) | 20 <u>Tennis Cardio</u> 9 - 10 Coaching 10 -11 Gardening Club 7.30pm Village Hall 'Climbers' | 21 Pilates with Rachel 9.30 am Village Hall Yoga w Diana 11.15-12.30 Village Hall | 22 | 23 <u>Tennis Cardio</u> 9 - 10am Junior Tennis Coaching 10 -2 A338 carriageway repairs 8pm - 6am see pages 3&4 | 24 <u>Tennis Mix in</u> 10.00 |
| 25  Voices of the Vale 7-9 pm Village Hall | 26 Yoga w Beth 0945-1045 Village Hall (please book) | 27 <u>Tennis Cardio</u> 9 - 10 Coaching 10 -11 | 28 Pilates with Rachel 9.30 am Village Hall Yoga w Diana 11.15-12.30 Village Hall | 29 | 30 <u>Tennis Cardio</u> 9 - 10am Junior Tennis Coaching 10 -2 Football 3pm St Andrew's Concert 7.30pm 'Cantemus' | 31 <u>Tennis Mix in</u> 10.00am |

* Most Events shown in the Calendar should still be booked in advance, and could also be changed at short notice. Please check the details before attending.
(Items underlined in the diary are hyperlinked)

In this issue:

| | | | |
|--|----|---|----|
| PARISH COUNCIL | 2 | LETCOMBES CONSERVATION GROUP | 11 |
| TRAFFIC REGULATION NOTICE FOR A338, MANOR ROAD | 3 | FIBRE OPTIC CABLING IN LETCOMBE REGIS SUMMARY | 12 |
| FURTHER MAPS OF DIVERSIONS A338 - OVERNIGHT 22 OCT | 4 | FIBRE OPTIC CONT... / KING ALFRED'S ACADEMY WALK | 13 |
| WINDOWS/BEAUTICIAN/ARBORIST/ELECTRICIAN/INTERIORS | 5 | GARDENING CLUB | 14 |
| GARDEN HELP WANTED/200 CLUB /LADDERADS/OVENU | 6 | BOOK BUFFS / FILM CLUB | 15 |
| TENNIS CLUB / FOOTBALL CLUB / YOGA WITH BETH | 7 | COMMUNITY HEALTH STRATEGY | 16 |
| SECURITY ADVICE -FROM PCSO / OXFORD SCIENCE FESTIVAL | 8 | RG&VH TRUST/ LETCOMBE CRICKET CLUB | 17 |
| ST ANDREW'S CONCERT / FILM CLUB / FIREWORKS | 9 | SPORTS & SOCIAL CLUB / BROWN BIN UPDATE / GREYHOUND | 18 |
| FRIENDS OF LETCOMBE VALLEY COMMUNITY NATURE RESERVE | 10 | WASTE CALENDAR / VILLAGE CONTACTS | 19 |



Message from the Parish Council

Thank you to all those who attended our recent Parish Council Meeting (20/9/21), via Zoom. The PC has unanimously agreed to continue, through the winter months, using this virtual platform, and review again in the spring. All members of the Parish Council are happy to be contacted, and the Parish Website displays our details. Also the Parish Clerk is available via the internet, letregispc@gmail.com, or you can phone and leave a message 07491000305.

We were pleased to welcome Mr Ian Robertson, the new Manager from Richmond to the meeting, we are both keen to strengthen the links between Richmond and the village. One potential project will be the Platinum Jubilee celebrations next June (2022). More details will be revealed in the coming months.

There are a number of initiatives being introduced locally, and in particular – Civil Parking Enforcement in the Vale, which will commence in November. Please be sure to park in designated places or you may well end up with a fine.

Elsewhere in the Register you will find a very helpful article on Scams and Phishing. We are grateful to our PCSO for providing this very useful update. Do take the time to read it, as it is even more important with today's reliance on the internet to keep yourself safe.

There is much discussion currently regarding initiatives and deals purporting to offer faster internet packages, and Cllr. Paul Batchelor has written a useful article to explain what we understand is happening. The PC continues to work with our District Councillor, Paul Barrow, and other Parish Councils, to ensure our voice is heard.

Following the circulation on the Village Email concerning the County Council's review of Recycling Centres, we hope that you have all taken the time to respond. The continued availability of the Stanford Tip is vital to keep our environment free from fly tipping and illegal rubbish dumping. We will communicate the outcome as soon as it is known.

Some good news this week, the Green Waste collection will resume, with some variations to the original scheme – details were circulated to the Village Email list. If you have not yet given your details to the Parish Clerk, please do so as soon as possible, as the Village Email is an excellent means of providing you with urgent information. You can be assured that your email will only be used for this purpose and will not be shared.

The Burial Ground improvements are well underway, and as well as improved access from the Recreation Ground side, better parking, including disabled parking bays, a new Lych Gate is to be erected to afford some shelter on bad weather days. The improvements will mean that there are enough plots for many generations to come, especially as the Church Graveyard at the corner of Bassett Road is also available for burials.

The PC was pleased to receive a request for a grant to support the Village Fireworks which is planned to take place on 6 November. The Village Hall & Recreation Ground Trust are planning to open the Pavilion with food and drinks available so please look out for details. This is always a very popular village event, not to be missed.

Finally, the latest information on Health Provision locally is that the Wantage Hospital will definitely reopen for out patients and other functions but decisions about in patient beds remain to be taken. In addition a plan has been submitted to the Vale to expand the Mably Way Health Centre. This is at the consultation stage so please make your views known via the Vale of the White Horse Planning website.

Please continue to take steps to remain safe,

Jeanne Lapsley
Chairman
Letcombe Regis Parish Council.



OXFORDSHIRE COUNTY COUNCIL

TRAFFIC REGULATION NOTICE ROAD TRAFFIC REGULATION ACT, 1984

Notice is hereby given pursuant to Section 14(2) of the Road Traffic Regulation Act, 1984, that the Oxfordshire County Council TEMPORARILY PROHIBITS THE USE OF AND WAITING ON THE HIGHWAY BY ALL MOTOR VEHICLES

- LOCATION:** Wantage, A338, Manor Road
- REASON:** To facilitate carriageway patching works
- DURATION:** Starting on 22 October 2021
The anticipated completion date is 23 October 2021(date included). This will operate between 20:00 and 06:00 (Traffic Regulation Notices cover a maximum of 5 consecutive days.)
- ACCESS:** Limited access will be maintained for emergency service vehicles and for frontages within the closed section of road, subject to the progress of the works

The "No Waiting" restriction means that wherever there are in place yellow "No Waiting" cones, you will not be able to park vehicles on the highway.

SUGGESTED ALTERNATIVE ROUTE: Light Traffic via B4494 Chain Hill, Un-named road between Boardhouse Plantation and Henley Cottages and A338, and Vice versa. Or HGV's via A417, A4185, A34, M4 and A338, and Vice Versa.

Paul Fermer
Paul Fermer, Assistant Director of Environment and Place

Date: 19 July 2021

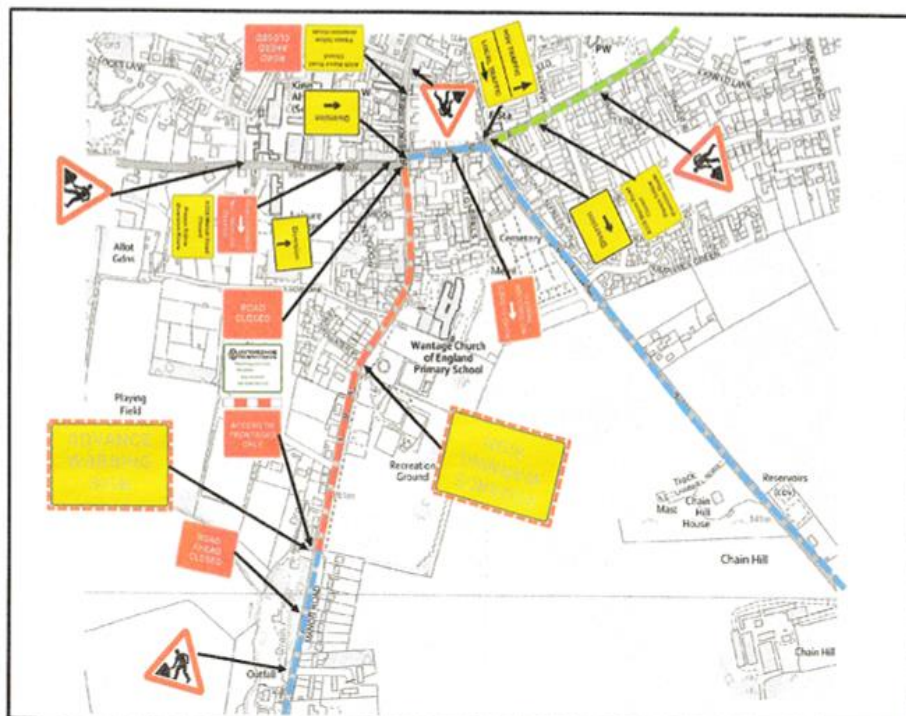
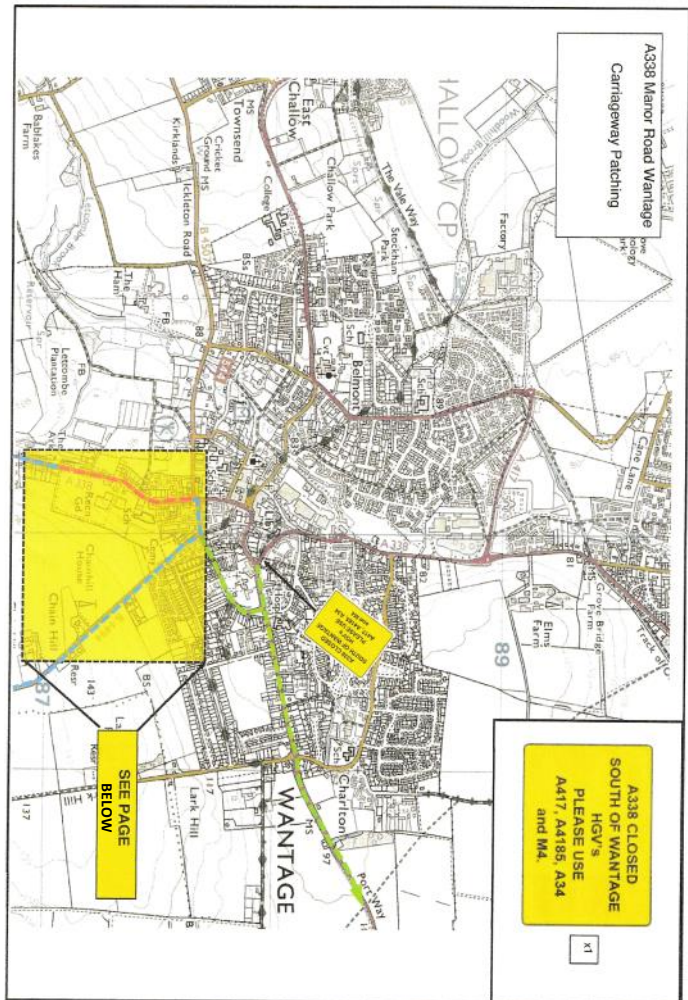

Advance Warning Sign Details (T)

Road Closed Here
22 Oct
(20:00-06:00)
For 1 Night
Please Follow
Diversion Route

A338 Manor Road Wantage
Carriageway Patching



- ROAD CLOSED x2
- ROAD AHEAD CLOSED x3
- ROAD CLOSED NO THROUGH TRAFFIC x1
- ROAD CLOSED NO THROUGH TRAFFIC x1
- ACCESS TO FRONTAGES ONLY x2
- OXFORDSHIRE COUNTY COUNCIL x2
- Diversion x2
- Diversion x2
- Diversion x2
- Diversion x1
- Diversion x2
- Diversion x1
- Diversion ENDS
- ADVANCE WARNING SIGN x2
- A338 Manor Road Closed x4
- Please follow diversion Route x4
- HGV TRAFFIC x1
- LOCAL TRAFFIC x1
- Diverted traffic x2
- Diverted traffic x1
- Diverted traffic x2

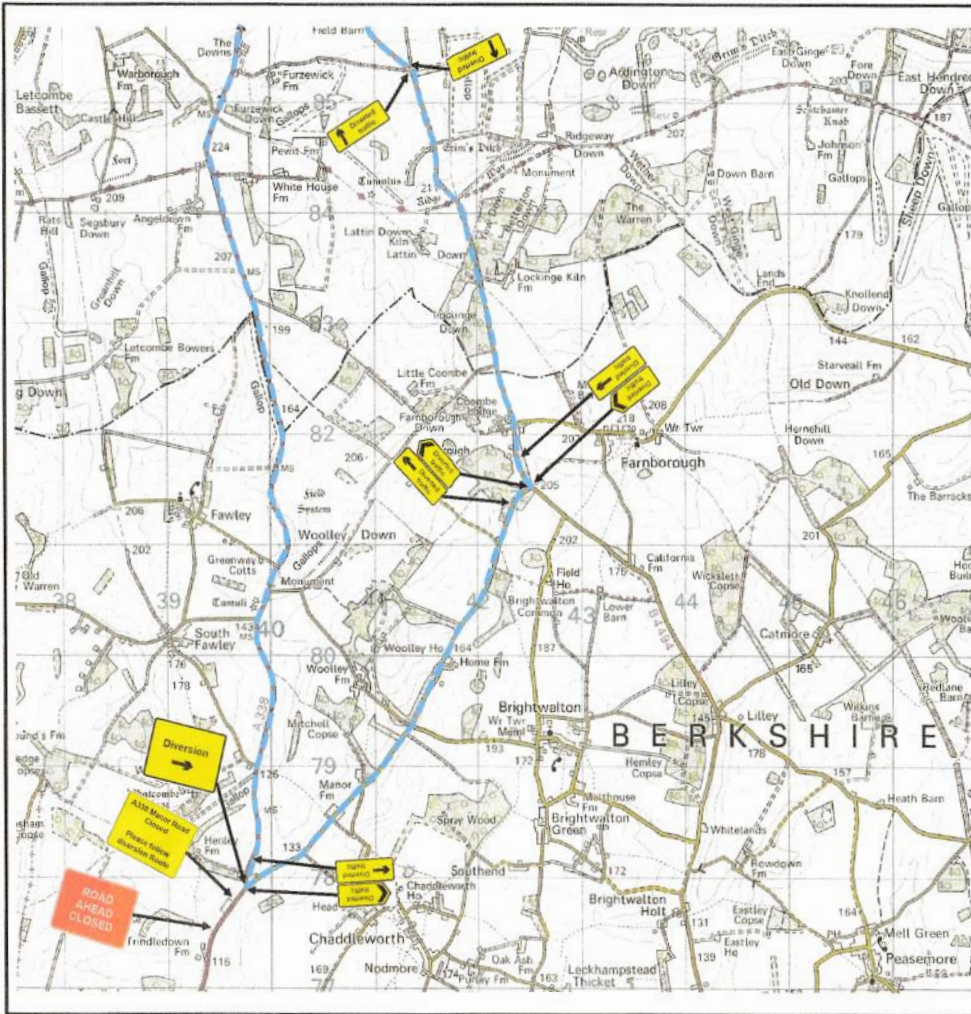

A338 Manor Road Wantage
Carriageway Patching

HGV relevant diversion
map below

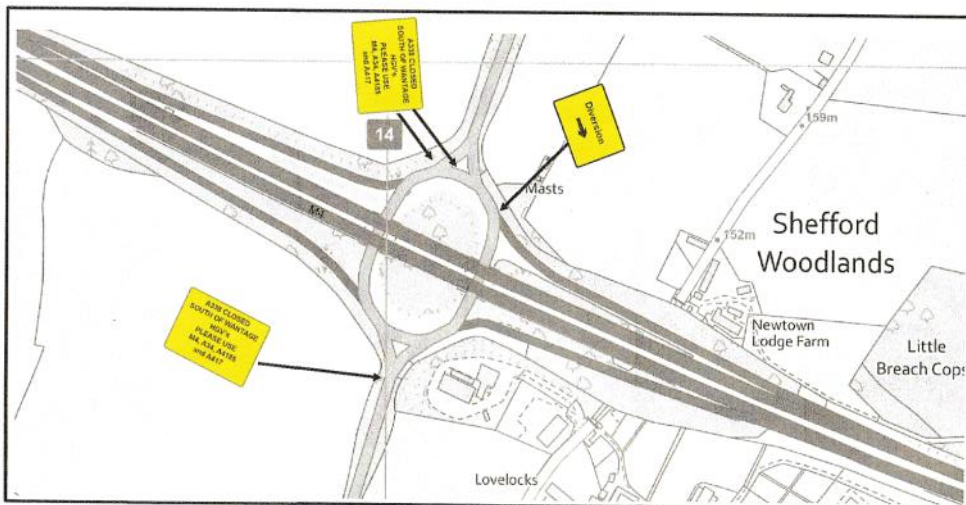

A338 CLOSED
SOUTH OF WANTAGE
HGV's
PLEASE USE
M4, A34, A4185
and A417

x2

A338 Manor Road Wantage
Carriageway Patching

Out of County Signage

MILLBROOK SERVICES

EST. SINCE 1994
PROFESSIONAL CARPET CLEANING
& WINDOW CLEANING
FULLY INSURED

millbrookservices1@gmail.com

TEL: 01235 511541 MOB: 078144 28395
DIDCOT, OXFORDSHIRE

Visit our webpage to view all our services

www.millbrookcleaning.co.uk



Hazel Lee Jones
Holistic Beauty Therapist

19 Westbrook Grove OX12 0AP

Mrsjbeautyhealing@gmail.com

Mrs Jones Beauty Grove

07375 362522

trotter treeworks

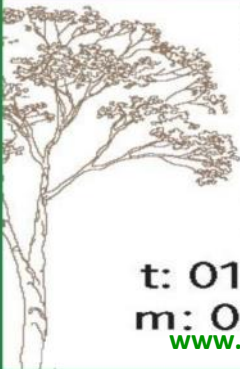

Ian Trotter – arborist
NC Arb, ISA Cert Arb

- tree crown reducing/
thinning/lifting/reshaping
- pollarding
- tree felling/dismantling
- fruit tree pruning
- hedge trimming/removals

t: 01235 258575
m: 07771 538575
www.trottertreeworks.co.uk



Gabi's Cleaning Service

*Cleaning at its finest
High quality, friendly and flexible
cleaning service.
Ironing~Carpet cleaning*

07771391209 ~ gabipapp@icloud.com

D K Electrical Services

Daniel
Electrician

07817 457832

Daniel-Electrician@outlook.com

City & Guilds

Domestic clients only



MERRICK INTERIORS

*for all your interior design, curtaining,
upholstery and
soft furnishing requirements
contact 07736707922,*

enquires@merrickinteriors.co.uk



GARDEN HELP

We are looking for a young and reasonably strong boy or girl to help with weekend garden work in Letcombe Bassett. Required for 4-5 hours most weekends. If interested phone Tony 07968-101723 to discuss. No previous experience necessary.

Mel Taylor Dog Training

Fun and Engaging Dog Training for you and your Puppy/Dog
Positive reward based training to get real life results.
Agility Training for Fun or Competition
See website for full details.
www.meltaylordogtraining.co.uk

**COMPUTER PROBLEMS?
CONVERSION TO WINDOWS 10?**

A locally-based service (from Letcombe Bassett) has been helping people here for the last 15 years
Moderate Rates Same Day Service
Charles Rowe Tel: (01235) 766000 anytime
Email: ccrowe@waitrose.com

Personal Assistant/Carer

DBS checked/insured
Teaching/Management background.
Five years as an Activity Organiser in residential homes
For help or support please call 07968983673

Hazel Lee Painter & Decorator

Interior & Exterior. Fully Insured.
Local & Reliable Female Decorator
No job too small Mob: 07866 509683
hazel.lee78@hotmail.co.uk

Mel Taylor Photography

Providing Dog, Equine, Newborn & Child Portrait Photography
Studio or Location shoots,
NEW GREETING CARDS & POSTCARDS for sale
Local Wildlife and Scenes. See website for full details
www.meltaylorphotography.co.uk

Registered Dietitian

Liane Reeves, BSc (Hons) Nutrition, MSc Allergy
HCPC registered, MBDA

Expert personalised dietary advice for teens and adults. Consultations held at Wantage Osteopathic Practice, 1 Church St. Wantage. To discuss how dietary advice can help you and to arrange an appointment: Tel: 07947 053396
Email: info@reevesdiets.co.uk www.reevesdiets.co.uk

**Springboard Coaching,
Mentoring & Leadership Development**



It's your turn..
Maximise your potential and enhance your wellbeing. Find new ways to meet challenge and flourish in change. Contact Suzy Alder for a free chemistry session.
International Coach and mentor. Applied positive Psychology Practitioner.
aldersuzy@outlook.com / 07774686877

| | | |
|----------------------|------------------------|--------------|
| 200 Club Draw — No 7 | | October 2021 |
| 59 | Vivien McCOUBREY | £50 |
| 93 | Julie BATTEN | £25 |
| 187 | Peter BELLIS | £15 |
| 237 | Helen WATTIE | £10 |
| 73 | Phil HODGSON | £5 |
| Special Draw: | | |
| 158 | Thérèse CLARKE | £25 |
| 46 | Martin & Jane SAMUEL | £20 |
| 175 | Alexander LAPSLEY-MIKA | £10 |
| 76 | Carole & Geoff HAMER | £10 |
| 161 | Thérèse CLARKE | £10 |
| 116 | Christine GILLIBRAND | £10 |
| 179 | Robin GLYN | £10 |
| New Numbers Draw | | |
| 97 | Mandy PITMAN | £5 |

We Clean Ovens

...so you don't have to!

Call us today to have your cooking appliances sparkling, using our own eco friendly products.



Our oven cleaning experts will leave you free to enjoy your valuable leisure time.



oven
oven valeting service
Local | National | Affordable

Call TODAY for LOCAL Service **01235 239938**
oven.co.uk/oven_cleaning/south-oxon

Autumn Adult Tournament.

Adult American Doubles Tournament (Alias “Happy Social get together”). Fun event, OPEN to all Abilities, on **Sunday the 10th of October** Drinks and snacks provided 10:00 am > 13:00pm. To just come for a drink or take part, please either: ring **Anne Jones on 763969**, to book or email [Letcombe tennis](mailto:Letcombe.tennis). This is the perfect opportunity for new and rusty members to join in and have fun.

Club Sessions

The Wednesday evening Mix in sessions will stop at the end of October (may be one day we will get Flood Lights so we can continue all year round!!)
 Every Sunday morning one of our committee will be at the courts from 10am to 1 pm (weather permitting) to meet and knock up with you, so please come along, to play a friendly game, find out more or just knock a ball about.

Letcombe Football Club



A mixed start to the league season. We opened the campaign with a 4-1 defeat at home to a strong Wantage Town development side, but then responded well to beat Faringdon Town away by the same score. We lost 3-2 at home against a young Swindon Supermarine development team, but came back well in the second half and deserved a draw after trailing by 3 goals at the interval. Our visit to Kintbury ended in a 1-1, and although we had chances to win the game, it was probably a fair result.

Fixtures in October are :

| | | | | | |
|----------|------------------|------------------------|---|------------------------|------|
| Saturday | 2 nd | Letcombe | v | Fairford Town Reserves | 3.00 |
| Saturday | 2 nd | Lambourn Reserves | v | Letcombe Reserves | 2.00 |
| Saturday | 9 th | Shrivenham Development | v | Letcombe | 3.00 |
| Saturday | 9 th | Letcombe Reserves | v | Stanford in the Vale | 2.00 |
| Saturday | 16 th | Letcombe | v | Newbury | 3.00 |
| Saturday | 16 th | Letcombe Reserves | | TBA | |
| Saturday | 23 rd | Hungerford Swifts | v | Letcombe | 3.00 |
| Saturday | 23 rd | Letcombe Reserves | | TBA | |
| Saturday | 30 th | Letcombe | v | Carterton | 3.00 |
| Saturday | 30 th | Letcombe Reserves | | TBA | |



Yoga with Beth

Newcomers are welcome to join our lovely friendly group but please contact me on 07790 015762 to book first.



Phishing, Smishing and Vishing

What it is

Any website, online service, phone call or text message that poses as a company or brand you recognise.

Any contact like this is designed to convince you to hand over valuable personal details or your money, or download something that infects your computer.

The three terms are all plays on the word 'fishing', in that the fraudsters fish for potential victims by sending emails, social media messages or text messages or making phone calls with urgent messages in the hope of persuading someone to visit the bogus website

Phishing is a method employed by Fraudsters to try and obtain personal details such as user names and passwords. Phishing is carried out by sending spoof e-mails or instant messaging. Often the e-mail will look like it is genuine and will contain links that take victims to a website that looks identical to the genuine web site. Victims will then attempt to log into the site and in so doing will disclose their username and password. The fraudster then uses the log in details to commit fraud.

Smishing is when fraudsters obtain personal details of a victim by SMS text messages. SMS phishing uses phone text messages to deliver the bait to induce people to divulge their personal information. Fraudsters can go on to use this personal information to commit fraud.

Vishing is when fraudsters obtain personal details of a victim by phone.

What to look out for and what you should do if you receive a phishing message

- **Be aware and pro-active:** When responding to emails or phone calls, never give your login or personal details. If you receive an email from a company that claims to be legitimate but is requesting these details, or a contact number tell them you will call them back. Use a contact number for the organisation that you have sourced reputable. Speak to them directly to confirm that the message is genuine
- **Use your spam filter:** If you detect a phishing email, mark the message as spam and delete it. This ensures that the message cannot reach your inbox in future
- **Know your source:** Never respond to a message from an unknown source. Take care not to click any embedded links. Phishing emails are sent to a vast number of randomly generated addresses. However, clicking embedded links can provide verification of your active email address. Once this occurs it may facilitate the targeting of further malicious emails. Even "unsubscribe" links can be malicious. Ensure that the email is from a trusted source and you are, in fact, subscribed to the service.

PCSO Tom Wallcott-Smith

9 - 26 October 2021



IF Oxford, the city's science and ideas Festival returns in October with a mix of 100 in person and digital events for all ages. Topics range from the chemistry of cooking to stories of animal migration, and advances in medical technology to the science of whisky distilling.

For full details please go to www.if-oxford.com

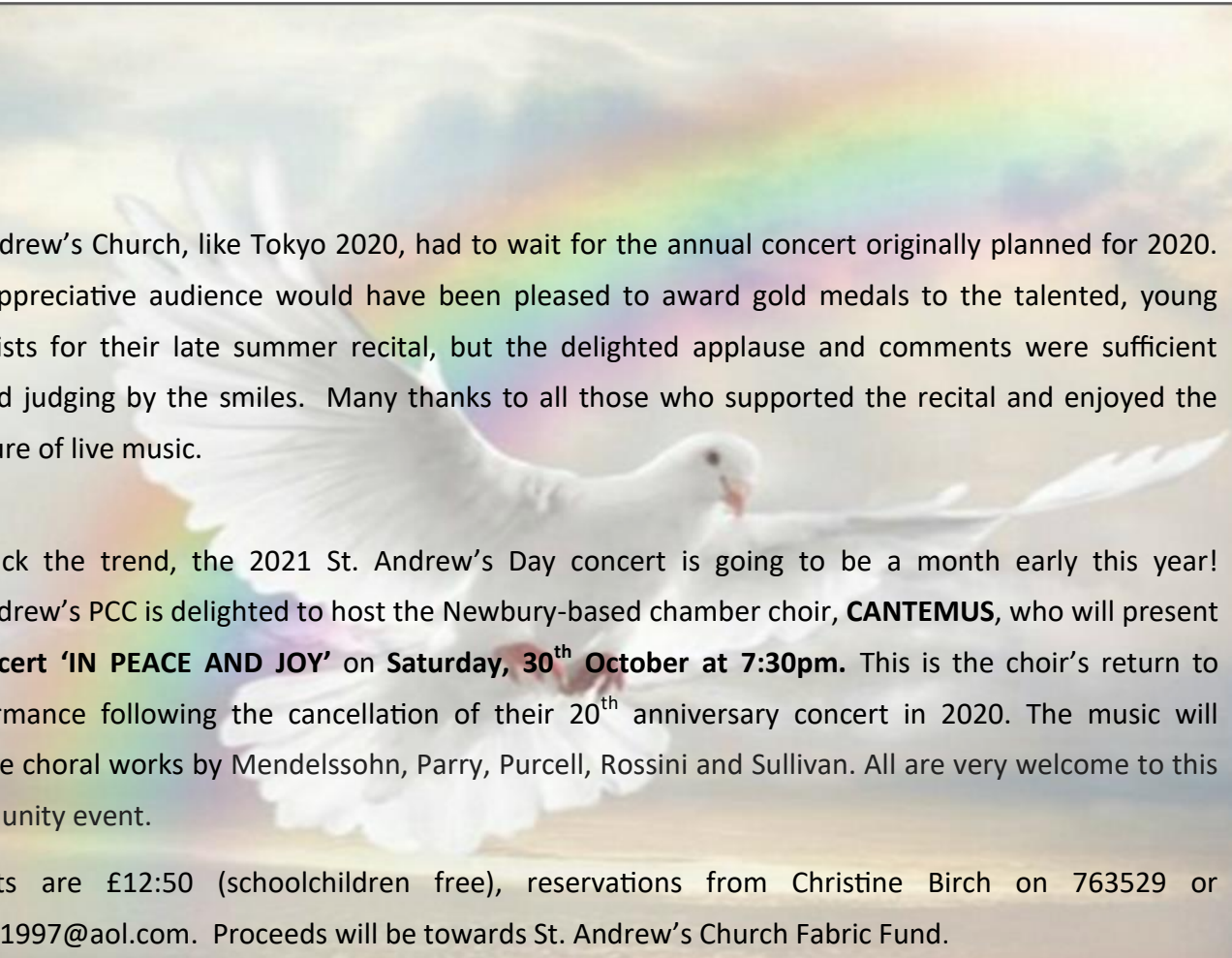

St. Andrew's Church, like Tokyo 2020, had to wait for the annual concert originally planned for 2020. The appreciative audience would have been pleased to award gold medals to the talented, young organists for their late summer recital, but the delighted applause and comments were sufficient reward judging by the smiles. Many thanks to all those who supported the recital and enjoyed the pleasure of live music.

To buck the trend, the 2021 St. Andrew's Day concert is going to be a month early this year! St. Andrew's PCC is delighted to host the Newbury-based chamber choir, **CANTEMUS**, who will present a concert **'IN PEACE AND JOY'** on **Saturday, 30th October at 7:30pm**. This is the choir's return to performance following the cancellation of their 20th anniversary concert in 2020. The music will include choral works by Mendelssohn, Parry, Purcell, Rossini and Sullivan. All are very welcome to this community event.

Tickets are £12:50 (schoolchildren free), reservations from Christine Birch on 763529 or cbirch1997@aol.com. Proceeds will be towards St. Andrew's Church Fabric Fund.



LETCOMBE FILM CLUB

**Letcombe Regis Village Hall,
Wednesday 13th October**

**Tickets £5 Doors open 7.30pm
Film starts at 8.00 pm**

Refreshments - Soft Drinks, Wine, Beer and Tea/Coffee

LETCOMBE REGIS RECREATION GROUND

2021 BONFIRE AND FIREWORKS DISPLAY



Saturday 6th November

Bonfire 6.00pm

Fireworks 6.30pm

- ✈ Entrance free (there will be a bucket collection in aid of Recreation Ground funds on the night)
 - ✈ Clubhouse open for food and drinks
 - ✈ Sparklers on sale
- 

To help towards a more balanced display, villagers are encouraged to contribute advance donations of money towards the fireworks.



Please donate by Monday 1st November to:
Richard Taylor, 3, Croft End, 763359
Cheques payable to:
"Letcombe Regis Recreation Ground"

COME AND ENJOY YOURSELVES!

Financially supported by the Parish Council.
Organised by the Letcombe Regis Recreation Ground and Village Hall Management Committee



Friends of the Letcombe Valley Community Nature Reserve

Autumn is the season of plentiful berries in the Reserve. In late summer, each elderflower formed a berry, in the true botanical definition of a fleshy fruit containing seeds produced from the ovary of a single flower. These will be used as a food source this month by a variety of birds, butterflies and mammals such as squirrels and deer.



The berries (left) are rich in sugars and are easily pulled off their slender stalks making them attractive to small migratory warblers, blackcaps and whitethroats, as well as larger blackbirds and woodpigeons. Insects are drawn to the bruised fruit providing a feast for insectivores. Elderberries are closely followed by blackberries, not actually true berries in the botanical sense, which also are non-toxic and only stay at their best for a short period before toxic moulds grow on them in damper conditions. Late butterflies feed on blackberries for the sweet juices, as do squirrels and badgers. Fruit with longer preservation periods are left untouched by birds until other food

sources are scarce, and those with mild toxicity, like ivy, are only consumed in low numbers at any one sitting. In this way, the supply of berries for wildlife will last long into the winter.

The deep red berries (left with ivy berries) of Hawthorn are particularly plentiful this year and will feed more than 300 species of insect. Hawthorn berries support many birds including thrushes and migratory redwings and fieldfares, whilst the sharp thorns give security to groups of smaller birds in the bushes such as Long-tailed tits (*Aegithalos cadatus*). The larger blue-black sloes (right) of Blackthorn (*Prunus spinose*) are too big for small songbirds but are of value to insects and larger birds, such as thrushes and hawfinches, the latter eating the hard seed as well as the flesh.



The dusty blue colouration that these fruits develop is a yeast bloom which enhances ultraviolet light reflection coincidentally making them stand out more to



birds with their UV vision enabling them to perceive colour contrasts which are invisible to people. The berries of the Spindle tree (*Euonymus europaea*) look more exotic with their vibrant pink fruits containing bright orange seeds (right). They are a valuable food for bird, mice



and foxes but, though attractive visually to people, both leaves and berries are toxic to humans. The Guelder rose (*Viburnum opulus*) has bunches of translucent, vivid red berries (left) that are an important food source for birds, including bullfinches and mistle thrushes, but is another bush with berries toxic to humans. The bright red, oval berries of the Dog rose will be eaten by larger birds like blackbirds, redwings, fieldfares and, if any hips are left later in the



year, by waxwings. All these are a small selection of the berries sustaining wildlife in the Reserve.

Monthly work parties will continue on the third Saturday of each month, the next one is on 16 October between 13:30 and 16:30. Please meet near the pond notice board on the Community Reserve by 13:20 for the tasks and safety briefing. As you are aware, extra caution is still advisable, so please bring your own work gloves, mask, drink, and snack if you plan to join the work party. Email letcombevalley@gmail.com to join the volunteers' circulation list.



The Letcombes Conservation Group

Most people will be aware of the association between the late Prince Philip, Duke of Edinburgh, and the World Wildlife Fund, founded in 1961, now renamed the World Wide Fund for Nature, and 60 years later the world's leading non-governmental conservation organisation with a mission to create a world in which people and wildlife can thrive together. The advantage of global travel, at a time when this was the exception rather than the norm for holidays, convinced Prince Philip of the urgency of wilderness preservation and for a fund-raising organisation to support the work of existing conservation groups. However, the organisation soon evolved into running its own projects with scientists focussed on 'ecoregions' in the areas of forest, freshwater and marine habitat conservation, endangered species conservation, climate change, and the elimination of the toxic chemicals across many countries.



Another of the founders, Sir Peter Scott, famously stated, 'We shall not save all we should like to, but we shall save a great deal more than if we had never tried'.

It is not surprising, therefore, that to mark Her Majesty's Platinum Jubilee in 2022 a tree planting initiative has been created named The Queen's Green Canopy (QGC). Everyone across the UK is invited to plant trees from this month until March 2022, the ideal tree planting season, though any tree planted through to the end of the Jubilee year of 2022 can be part of the QGC. Rather than concentrating on a few civic trees, the QGC aims to create a network of individual trees, avenues, copses and whole woodlands in honour of The Queen's service and the legacy she has built. Every tree planted that reaches maturity will make a difference bringing benefits to wildlife, people and climate in the short term and creating a green legacy for the future.



A fantastic diversity of wildlife are supported by trees, in the case of British oak trees an estimated 2,300 species. Green spaces in the UK remove up to 1.3 billion kg of pollutants from the air each year creating a healthier environment. Each mature tree is estimated to absorb up to 150kg of CO₂ each year; though some of the gas is returned via photosynthesis, a proportion of the carbon is fixed in the tree tissue as it grows. In urban localities the air temperature can be cooled by 2 to 8 degrees by well-placed trees providing shade.

Suitable trees need to be chosen with the locality in mind and have the best chance of flourishing if they are native and sustainable in those conditions. They should be planted when the roots are dormant if purchased bare-rooted, though container-grown trees will establish before the tree is dormant for the winter or after April in suitable conditions. Advice is available online from a dedicated website for the initiative at [The Queen's Green Canopy](#) and on planting from the RHS or the Woodland Trust at [Trees and shrubs: planting / RHS Gardening](#) and [How to Plant Trees - Plant Trees - Woodland Trust](#). Each tree planted from October can be added to a national map on the QGC website whether planted by an individual, a community group, a school or organisation. In addition, the initiative will dedicate a network of 70 Ancient Woodlands across the UK and identify 70 Ancient Trees to celebrate Her Majesty's 70 years of service. So this autumn and winter make a difference for the future, **Plant a Tree for the Jubilee.**





Developing The Fibre Optic Cable Communications in Letcombe Regis

The previous issue of the Register contained an article on the current status of the development of the ultrafast fibre optic broadband cable developments in the village. Since its publication the Parish Council have been working with other parishes and the County Council to try and ensure that Letcombe Regis and the surrounding areas are able to benefit from schemes as they evolve. One aspect of this work is to keep residents informed of developments and the issues that they will face as the possible new arrangements begin to appear. This will help ensure that people can make an informed decision as to which is the most appropriate arrangement to meet their needs.

This article will outline the context of the fibre optic cable developments along with the proposed timetable. It is divided into three further sections: why the change to fibre optic systems; what exactly is involved, and; how arrangements are currently progressing. Depending on what residents would like information on, the Parish Council will follow up in subsequent articles how matters are progressing and what steps residents need to take if they wish to have access to what is termed 'ultrafast' broadband.

What exactly is changing and why?

For telecommunications we have relied on a copper wire based system for over a 100 years. The arrangements through which both communications and broadband services using analogue and digital technologies are managed is by BT Openreach, an independent division of British Telecommunications. They are responsible for the copper wires, fibre cables and other elements of the infrastructure which connects homes to local exchanges.

There are three types of connections possible using the current infrastructure. These are: Public Switched Telephone Network (PSTN), the copper wire based system used for voice communication; Asymmetric Digital Subscriber Line (ADSL), which uses the copper wire based system but, with some additional equipment, allows internet access as well as voice communication, and; Integrated Services Digital Network (ISDN), which, while also using copper wire allows transmission using digital not analogue signals.

BT Openreach have announced that they are 'closing' the copper wire based arrangements by 2026. This does not mean that all premises will have to be converted to a fibre optic system, simply that any new arrangements will be based around a fibre optic cable system and the existing ADSL and ISDN lines would be replaced.

There are a considerable number of advantages to the move including:

- (i) Durability and reliability. The copper wire based system is more prone to breakage and hence require greater maintenance than the equivalent fibreoptic (glass) system. In countries which have already seen a switch data suggest that there up to 70% fewer faults.
- (ii) Speed. The maximum speed that copper wire can transmit data is around 50Mbps (Megabytes per second). This may sound like a huge capacity but with the growth in internet usage, for example downloading of material and video linking, it is currently barely adequate to meet demand. Indeed, as a household increases the number of users the speed of transmission drops considerably. Fibreoptic cabling arrangements will allow speeds of up to 1000Mbps.
- (iii) Size. Fibreoptic cabling is far smaller in diameter than copper wire. This will allow more cabling to be installed into the existing conduits used for copper wire and hence less disruption as demand for services increases.
- (iv) Consistency. Fibre broadband is more resistant to 'line drops' when the service disappears for brief periods. While such drops are not too challenging for simple web-browsing it is more irksome for watching video and TV online (which is rapidly becoming the norm) and the inevitable working-from-home video calls.
- (v) Property prices. Surveys and research show that buyers are now prepared to pay more for homes with fibre broadband. The recent COVID lockdowns have shown the importance of reliable, durable, speedy and consistent broadband for working from home and spending more time watching online entertainment. With the requirement for all new builds to have fibre broadband and the sheer number of new builds in and around Wantage, it is clear that, even if we might not appreciate a fibre broadband connection, potential buyers of our homes will look elsewhere if we do not have it.
- (vi) Cost. As fibre broadband is rolled out, any cost differential to the existing copper connections is being competed away. Having the ability to connect to fibre does not mean you need to pay for the fastest service.

In summary, the move to fibreoptic cabling is a national programme which will see a number of improvements over existing arrangements. It would meet the increased demand better, not least with greater reliance on working from home, and in theory provide cheaper services when compared to maintaining the copper wire based arrangements.

What exactly is involved?

At present Letcombe Regis is served by a combined fibreoptic cable and copper based arrangement. There is cabling into the village from the main exchange at Wantage (the cabinet is situated at the bottom of Court Hill Road) and from there, copper wire is used to connect each household. This arrangement is known as Fibre To The Cabinet (FFTC). Under the proposed developments this will be altered to Fibre To The Premises (FTTP), which will see the fibreoptic cabling throughout the system.

During the changeover some disruption will occur, although the extent of this is unclear until the company awarded the contract to undertake the work has carried out its survey. Ideally, the existing conduits will be able to carry the cabling and the present telegraph poles will be used. However, any changes to the conduit arrangements may mean roadworks and work on the telegraph pole arrangements will no doubt be required.

In addition, current phone systems that use copper wire based arrangements will not work with those using fibre optic cabling. This issue will be covered in a later article as the proposals for the new arrangements are firmed up.

Progress of current arrangements.

The time schedule for the changes covering Letcombe Regis can be found on the BT OpenReach website (see: <https://www.openreach.com/fibre-broadband/where-when-building-ultrafast-full-fibre-broadband>). The move is scheduled to be completed by April 2025. However, at present the contractor to supply the infrastructure has yet to be appointed, indeed Airband's letter that was referred to in last month's article in the Register is I would argue more about it trying to gauge the size of its potential customer base than actually providing a service.

While a cable has been installed by Airband on Warborough Road, the funding from this was supported as part of the rural business development scheme, (mis) managed by the Department of the Environment. Airband at the time stated that the cable could not be extended to support the village and an alternative routing would be required.

It is hoped that the contractor for the cabling infrastructure will be appointed within the next few months. Working with other parishes and the County Council we are trying to ensure that developments go as smoothly and as cheaply as possible. This is heavily dependent upon the numbers of households which feel that adopting the FTTP system best meets both their current but especially future needs.

As mentioned previously this is the first of a proposed series of articles to help inform and reassure people. As developments occur the Parish Council will keep parishioners informed using the Register but if people do have question please contact me directly using my email address (paulb@public-health.ucl.ac.uk) or by dropping a note into the letter box at The Old Manor Stables.

King Alfred's Academy walk



Dear Resident

As you may be aware, each year King Alfred's organises an annual sponsored walk for all of the students and members of staff. It is one of the main fundraising events in the Academy calendar and is hugely successful. This year's event takes place on Friday 8th October and I thought I would let you now in advance so that we can do all we can to minimise any disruption to you.

This years' route will take half the students from West Site (Challow Road) and up onto the Ridgeway via Challow and the Letcombes. Once they have walked along the Ridgeway they will re-enter Letcombe village via Warborough Road and will then walk through the village and exit via the footpath that leads directly back to King Alfred's Centre site playing fields. The other half of the students will be walking the route in reverse from Centre Site (Portway) to West Site (Challow Road). Therefore, we anticipate large numbers of students walking through the residential areas between approximately 9.15 am - 10.15am and then a steady stream of walkers between approximately 11.00 am - 1.00 pm. Throughout the route staff will be acting as marshals (All of which will be wearing bright yellow Hi-Viz jackets) and should you have any concerns during the day whatsoever please either approach one of these members of staff directly or call the Academy on 01235 225700.

If we have to cancel the walk due to poor weather conditions, we will endeavour to hold it during the summer term.

As in previous years I hope that the day will be immense fun for everyone involved, and thank you for your support of our fundraising event.

Kind Regards

Yours sincerely

Rick Holroyd

Headteacher



Issue 194

Letcombes Gardening Club

Topical Tips

Forgive me for thinking that we are just entering September but this last month has been so glorious that it's been more like summer!

There are lots to look forward to this month though, despite the prospect of less warmth and sun. The leaves will be changing colour and this is always a feast for the eyes.

There are, however, some jobs that need to be done so we can't just sit and look! You can lift and divide perennials this month; it isn't a job that is just confined to spring. It's a good time to do this because not only is the soil nice and warm but you can still see the plants whereas in spring you have to rely more on what you remember from the previous year!

You can trim back perennials but don't be too enthusiastic about this, as some seed heads look really attractive covered in frost.

Don't be too hasty about lifting dahlia tubers, as you need the frost to blacken the top growth first. You can lift tender bulbs now though and you also need to keep a watch on the weather and move tender perennials inside before the first frosts.

Many plants get killed off from waterlogging rather than cold and this applies to plants in pots too so raise the pots on pot feet to prevent this happening.

Lets move on to trees and shrubs. It's your last chance to prune deciduous hedges now. You can also trim to halfway those shrubs that you usually cut right back in spring to prevent wind rock.

October is also a good time to plant and move trees and shrubs.

Why not try some more advanced propagation? Have a go at hardwood cuttings. This works with roses. You can also collect berries, like rowan, and have a go at sowing them.

Lets spare a thought for our houseplants. As the days shorten you should reduce watering and if any are tropical it pays to stand them on beds of gravel so you can keep the humidity up when the central heating goes on.

Now lets finish off with fruit and veg and I have to quote a passage I found on the web about October as it really tickled my fancy!

'October is usually a month full of chilly mornings and spooky nights – the kind of weather that puts you in mind of hot mugs of tea, bowls of soup and if you're an allotment gardener, lots of lovely winter digging!'

It says it all really! Keep on harvesting and make sure you lift any crops that are likely to be damaged by frost.

You can sow winter lettuce and also winter hardy peas and broad beans so that you get an early crop next year.

It is also a good time to lift and divide rhubarb crowns (lots for friends) and to plant new crowns.

Make sure you stake your sprouts and purple sprouting otherwise they will all end up horizontal with the autumn winds! Other than that we're talking about tidying up for the winter.

So get out into the garden and enjoy that autumn colour!

The Letcombes Gardening Club

We had a wonderful, peaceful meeting in September in the Parkinsons.me garden for our first face-to-face event. The weather was glorious and we all sat outside in the sunshine for the talk. This month our meeting will take place on Wednesday 20 October at 7.30pm in Letcombe Regis village hall. Our speaker for the evening will be Pip Bensley and her topic will be '*Everything you need to know about climbers*'. Pip has a wealth of horticultural knowledge and has written a book on climbers so we are in for a treat. Do join us if you can.



Book Buffs

Change of DATE/PLACE and TIME

For the winter months we are reverting to our former meeting days and place. Meetings will be held on the first Wednesday of the month in the Greyhound. So the next meeting is on Wednesday 3rd November in the Greyhound at 8 pm when we shall be reviewing:

'Pereira Maintains' by Antonio Tabucchi and the alternative:

'One August Night' by Victoria Hislop (a sequel to 'The Island')

Film Club

Official Secrets (15 rating)

Wednesday October 13.



What a return for Film Club! Almost 50 film club fans came to see *The Sapphires* in September, our first screening since March 2020. It was great to see so many of our regulars and some new faces too. Thank you, and welcome back!





We have another cracking film for you this month. With '**Official Secrets**' we return to one of our most popular genre's, a spy drama, this time based on the true story of GCHQ whistleblower Katherine Gunn. Adapted from the book 'The Spy who tried to stop a War', the film tells the story of Katherine, a young translator who in 2003 leaked a memo which exposed an illegal spy operation between British and American intelligence services in the run up to the Iraq War.

Even if you remember the news coverage and know the outcome, this is a compelling film, with excellent performances from an all star cast of British actors. Keira Knightly shines in the lead role as idealist Katherine Dunn, ably supported by Matt Smith, Matthew Goode amongst many others, including a stellar performance by Ralph Fiennes as human rights lawyer Ben Emerson. Released in 2019 at the Sundance Film Festival, **Official Secrets** was critically acclaimed and is well worth watching.

We hope to see you on the 13th. Come early for a drink and a catch up with friends. Doors open at 7.30, film starts at 8pm.

COVID Safety

Although restrictions have been lifted, we want to make sure everyone feels safe and comfortable so have some precautions in place.

-  we ask that you wear masks while moving around the hall. You can remove masks while seated.
-  we will use more smaller tables so that you can sit in family/friends groups
-  please bring the exact money for entrance if possible (£5 per person)
-  sorry, no free popcorn on tables, but small bags will be available to buy
-  we will serve refreshments, please try to 'social distance' when you come to the bar.

If you have any questions or concerns please email us - letcombefilms@outlook.com

Future Film Club dates for your diary:

10 Nov: The Keeper

8 Dec: Dreamhorse

This is being developed apace. We were told that stakeholders and the public have been engaged (consulted in ordinary language). I asked how the public find out about the engagement and this is through the website. I am sure that not too many people have done this. **Please do so and ask residents to do so!**

The documents are available at <https://www.oxfordhealth.nhs.uk/news/oxford-health-community-services-strategy-development/>. These comprise the strategy document (38pp) and the database on which is it based (55 pages)

You can provide feedback by joining one of their online meetings (28, 30 Sept and 8 Oct) – see <https://www.oxfordhealth.nhs.uk/news/virtual-public-meetings-have-your-say-on-the-oxfordshire-community-services-review/>.

You can also mail your feedback (but **by October 10th**) to OCCG.talking.health@nhs.net or at communityservicesfeedback@oxfordhealth.nhs.uk.

Whilst looking at the document and thinking of your comments you might want to remember that Community Health is generally regarded as involving all health provision other than acute hospitals and GP surgeries.

Issues which give us some concern on HOSC include:

1. How the care sector is to be integrated adequately.
2. Palliative care provision.
3. The influence of budget constraints and workforce difficulties because the aims are laudable but what can be done might be more limited.
4. The Home First policy which is, where possible, to discharge patients home rather than to a community hospital because they generally recover faster.
5. How the community health provision will fit in with the Integrated Care System across Bucks-Oxon-West Berks (BOB ICS) where an increasing number of services are likely to be covered across county borders. This may not affect community health but we do not know so far.
6. Rural accessibility to health services.
7. Increasing demand on mental health services.

Please be wary of the questionnaire and where necessary be a critical friend. I am always worried where questions are posed where the answers are likely to be yes!

Cllr Dr Paul Barrow
Ridgeway Ward
JHOSC member

Recreation Ground and Village Hall

With Autumn well underway, the Recreation Ground is still looking well kept, and is also being well used. Thanks once again to the various Clubs and volunteers who look after it.

The Old Riding Field, after being levelled out, has been levelled out again after the Burial Ground improvements deposited several tonnes of soil on the area. We now need to get it harrowed, seeded and rolled, so that we can then maintain it for whatever purpose is decided.

Village Hall bookings continue to keep Claire, our coordinator, busy, and as ever, if you are looking to hire the Hall, then please check the online calendar and contact Claire. Please note that after being static for 5 years, the Trustees have reviewed the hire prices, and most of them have had a modest increase from 1st January 2022. See the Web Site for more details.

We have restarted the plan to renovate the Children's play area, thanks go to 2 villagers who have volunteered to take this forward, supported by the Trustees.

Bonfire Night and Fireworks will return this year. Make a note of the Date - Saturday 6th November. Traditionally we always hold it on the 5th November, but this year, it would clash with the Grove Rugby Club display, so we decided to move it by a day. See details on the poster in the Register. Villagers' garden rubbish is welcome to be put on the bonfire site from **Saturday 23rd October**

*** Note - no combustibles, metals, tyres or plastic please, as these obviously are not safe to put on a bonfire.** The site will be marked out ready from that day onwards. There will not be any vehicle access to the bonfire site, so please either use a wheelbarrow, or builders bags to transport your combustible rubbish to the site by hand. The Clubhouse will be open for refreshments from 5pm, with the bonfire being lit at 6pm, and fireworks at 6.30pm. Details will also be posted on the Letcombe Regis and Bassett Village Community Facebook page.

Richard Taylor
Chairman, Letcombe Regis Village Hall and Recreation Ground Trust.

Letcombe Cricket Club

The Cricket season came to a close, with the last game at home on Saturday 4th September. This was a defeat to the runaway league leaders Sunningwell. The Saturday team finished a respectable 5th out of 10 in Division 7C, winning 6 and losing 8, with 2 draws and 2 matches abandoned.



The Sunday Team had a fairly typical season for them, just about winning as many as they lost, although there were some cancellations later in the season because of player unavailability - mostly from opposition teams.

The Wednesday Team, playing in the Downs League Division 2 finished 4th out of 8, winning 7, losing 4, drawing 1 with 2 abandoned.

There has been major square renovation done in the past few weeks, with approximately 4 tonnes of loam, fertiliser and grass seed having been put on the square. Thanks go to Mark Roche from Challow (he used to play for Letcombe) for coordinating this work. We hope that the effort and expense will be worth it, but won't know for sure until the grass grows, and we start playing on it next season.

For now, cricket is starting its Winter break, although you may well see a few of the players turning out for the Letcombe Sports and Social Club darts team, when League matches start on Thursday 7th October.

Richard
Secretary, Letcombe Cricket Club



Letcombe Sports and Social Club

There has been plenty of activity over the past month at the Sports & Social Club, with members making the most of some lovely September weather. Unfortunately the elements have finally beaten our large gazebo into submission, although the smaller one is still standing firm, with a little help from some gaffer tape.

The "Pizza at the Pavilion" evenings at the end of August and September were enjoyed by many villagers, and thanks go to Kevin for cooking such excellent Pizzas! We will definitely be looking forward to him returning next year.

The Darts Team have been practising throughout the Summer, and are very much looking forward to League Darts returning on Thursday 7th October. The S&SC plan to have 2 teams in the Wantage & District Darts League. If you are interested in finding out more about the darts, or indeed are interested in playing then please contact me, and I will put you in touch with the captains.

Whilst the Burial Ground improvements are taking place, we have taken the opportunity to reclaim the part of the car park which had been overgrown along the side nearest the Burial Ground. There will also be improvements made to the car park drainage, and at long last the entrance potholes will be repaired.

At the last Sports & Social Club committee meeting, we discussed (amongst other things) whether the whole Clubhouse needed freshening up with a paintbrush, and we also are planning to improve the kitchen facilities.

If you are interested in learning more about the Sports & Social Club, or would like to become a Member (only £12 per year), then please contact the Secretary - letcombesportsclub@gmail.com.

Richard
Secretary, Letcombe Sports and Social Club

Brown Bin Garden waste collection

The VOWH have put Interim plans in place for a monthly Brown Bin collection for subscribers

The Letcombes' collection day will be Monday 11th October

Double the volume will be taken
Use cardboard boxes, compost bags, bin bags
NO trade waste bags

The full temporary calendar can be downloaded [HERE](#)

For other waste collection details
You can Download your own copy of the 21/22 Vale of the White Horse Waste calendar [Here](#)

Once you click on the download, it will take you to a PDF along with the holiday collection changes too.

THE GREYHOUND INN
LETCOMBE REGIS · OXFORDSHIRE

RETURN OF THE QUIZ
Sunday October 10th 8pm
Join Big Dave for a night of fun and prizes.
Kitchen open for dinner 6:30-7:30pm.
Charity supported: British Legion Poppy Appeal

We're Open Every Day Again!
Our kitchen opening times will be gradually increasing during the month of October
Tuesdays from 5th October, Mondays from 12th October
Please visit the web site for the latest information

Try our fixed price menu
Lunch for Less
2 courses £20 3 courses £24
Available Weekdays 12-2:30 pm

www.thegreyhoundletcombe.co.uk
email: info@thegreyhoundletcombe.co.uk
Tel:01235 771969

Deadline for inclusion is the 27th of each month.
Items will generally appear in the order they were received

Francesca Engelmann,
2, The Old Stables,
Letcombe Regis,
OX12 9LD

Register@oldstableyard.co.uk
01235 769310

IF YOU ARE NOT **ALREADY** ON THE VILLAGE EMAIL LIST AND WOULD LIKE TO RECEIVE, NOT JUST THE REGISTER, BUT ALSO UPDATES ON LOCAL ISSUES, DELIVERED DIRECT TO YOUR INBOX, PLEASE CONTACT THE PARISH CLERK: LETREGISPC@GMAIL.COM

Past Registers are available to view, along with much more information, on the Village Website:
www.letcomberegispc.org

The views expressed in the Register do not necessarily reflect the view of Letcombe Regis Parish Council

Waste Calendar

| October 2021 | | | | | | |
|-------------------------------|-----|-----|-----|------------------------|-----|-----|
| Mon | Tue | Wed | Thu | Fri | Sat | Sun |
| | | | | 1 | 2 | 3 |
| 4 | 5 | 6 | 7 | 8 | 9 | 10 |
| 11☆ | 12 | 13 | 14 | 15 | 16 | 17 |
| 18 | 19 | 20 | 21 | 22 | 23 | 24 |
| 25 | 26 | 27 | 28 | 29 | 30 | 31 |
| Green recycling Food waste | | | | Landfill Food waste | | |
| ☆Garden waste (double volume) | | | | | | |

Vale of Whitehorse Waste collection information can be found [HERE](#)